



**MANDATORY**

[www.eclipseaerospace.net](http://www.eclipseaerospace.net)

ECLIPSE  
AEROSPACE

## SERVICE BULLETIN

---

**NUMBER:** SB 500-26-003, REV A  
**MODEL:** ECLIPSE EA500  
**SUBJECT:** FIRE SUPPRESSION TUBING INSPECTION

### 1. PLANNING INFORMATION

#### A. Effectivity

Aircraft Serial Numbers 0001 - 0300.

#### B. Reason

This Service Bulletin has been prepared to inspect the right and left Fire Suppression Tubing.

#### C. Description

This Service Bulletin provides procedures to inspect the right and left Fire Suppression Tubing.

#### D. Relevant Publications

None

#### E. Compliance

Eclipse Aerospace Inc. considers this to be a mandatory inspection that must be accomplished at the next 300 hour / 24 Month Inspection or next cowling removal.

#### F. Approval

This Service Bulletin is based on engineering data that is FAA-approved, and the modification herein complies with the applicable regulations.

#### G. Labor Requirements

The following information is for planning purposes only.

(1) Estimated labor hours to perform:

Suggested number of personnel: 1

Job Set-up and Job Close-up: 1.0 Hour

Inspection: 1 Hour

**Total labor hours: 2.0**

The above is an estimate based on properly equipped and experienced personnel complying with this Service Bulletin. Actual labor hours may vary depending on workforce experience, concurrent maintenance, discovery of other discrepancies, etc.

(2) Qualification of personnel:

- A person properly authorized under 14 CFR 43 to perform aircraft maintenance.

#### H. Weight and Balance Change

None

#### I. Electrical Load Data Change

None



# SERVICE BULLETIN

**J. Software Accomplishment Summary**

None

**K. References**

Aircraft Maintenance Manual (AMM), P/N 06-117751, latest revision.

Illustrate Parts Catalog (IPC), P/N 06-117752, latest revision.

**L. Publications Affected**

None

**2. MATERIAL INFORMATION**

**A. Materials**

If damage is discovered, replace parts. Refer to the Illustrate Parts Catalog (IPC), P/N 06-117752.

**B. Tooling**

No tooling is required to accomplish this Service Bulletin.

**C. Interchangeability/Intermixability of Parts**

None

**D. Part Re-identification**

None.

**3. ACCOMPLISHMENT INSTRUCTIONS**

**A. Procedure**

(1) **Job Set-up,**

**SIGN OFF**

- (a) Make the aircraft safe for maintenance. Refer to AMM - 20-00-01 - MAKE SAFE FOR MAINTENANCE. \_\_\_\_\_

**WARNING: FIRE EXTINGUISHING SYSTEM USES EXPLOSIVES TO DISCHARGE THE FEC. MAKE SURE FEC IS ISOLATED FROM TRIGGER CIRCUIT POWER. OBEY THESE INSTRUCTIONS OR INJURY TO PERSONNEL CAN OCCUR.**

- (b) Open the circuit breakers that follow:

- ECB - L ENG FIRE EXTNGR (L FWD Bus)
- ECB - R ENG FIRE EXTNGR (R FWD Bus)

- (c) Remove Left Pylon Leading Edge - 311 EL. Refer to AMM - 54-30-11 - LEADING EDGE PYLON SKIN - REMOVAL. \_\_\_\_\_

- (d) Remove Left Upper Nacelle Cowl - 411 AT. Refer to AMM - 54-20-21 - UPPER NACELLE - REMOVAL. \_\_\_\_\_

- (e) Remove Right Pylon Leading Edge - 312 BR. Refer to AMM - 54-30-11 - LEADING EDGE PYLON SKIN - REMOVAL. \_\_\_\_\_

- (f) Remove Right Upper Nacelle Cowl - 412 AT. Refer to AMM - 54-20-21 - UPPER NACELLE - REMOVAL. \_\_\_\_\_



**MANDATORY**

ECLIPSE  
AEROSPACE

## SERVICE BULLETIN

---

(2) **Inspection**

- (a) Inspect Fire Suppression Tubing for condition. Replace tubing if damaged. \_\_\_\_\_
- (b) Make sure that the tubing is correctly installed through the fire barrier grommets (2, Figure 1). Make sure that tubing passes squarely through the grommet and that the grommet closes uniformly around the tubing. \_\_\_\_\_

**CAUTION:** MAKE SURE FIRE SUPPRESSION NOZZLE IS  
CORRECTLY ALIGNED, OR THE FIRE EXTINGUISHING  
SYSTEM MAY NOT RELEASE EXTINGUISHING AGENT  
IN CORRECT PATTERN.



**MANDATORY**

ECLIPSE  
AEROSPACE

# SERVICE BULLETIN

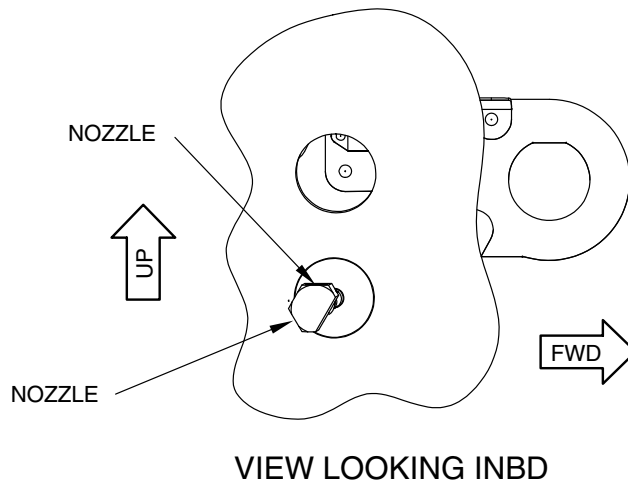
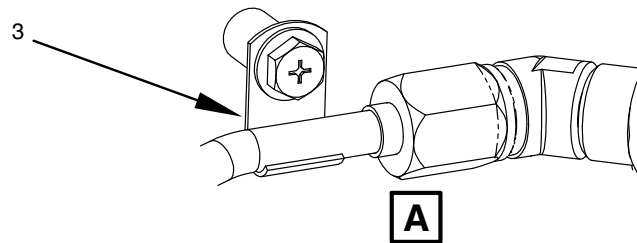
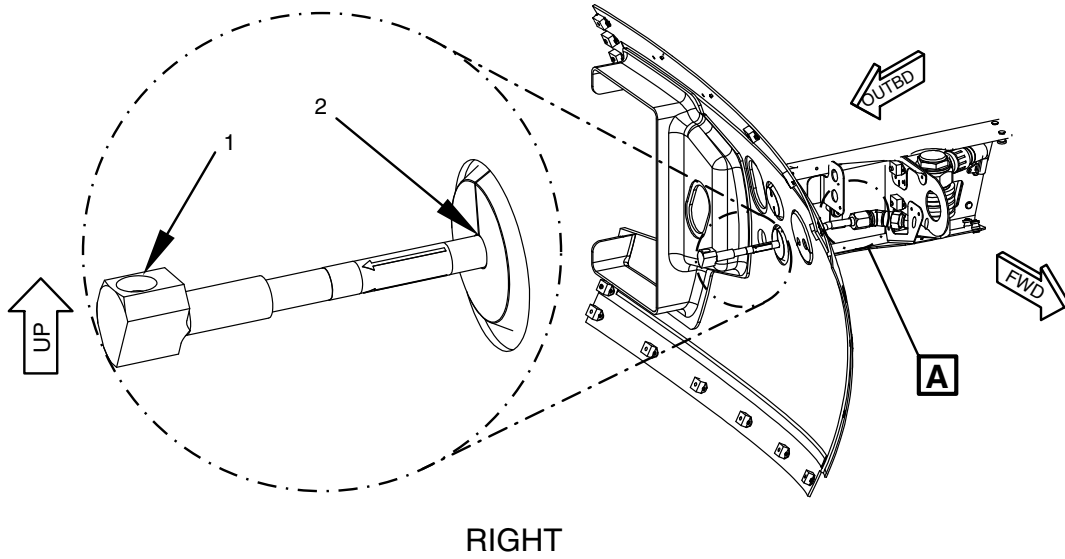

**Right Fire Suppression Tubing  
Figure 1 (Sheet 1 of 2)**

5121591A



# SERVICE BULLETIN

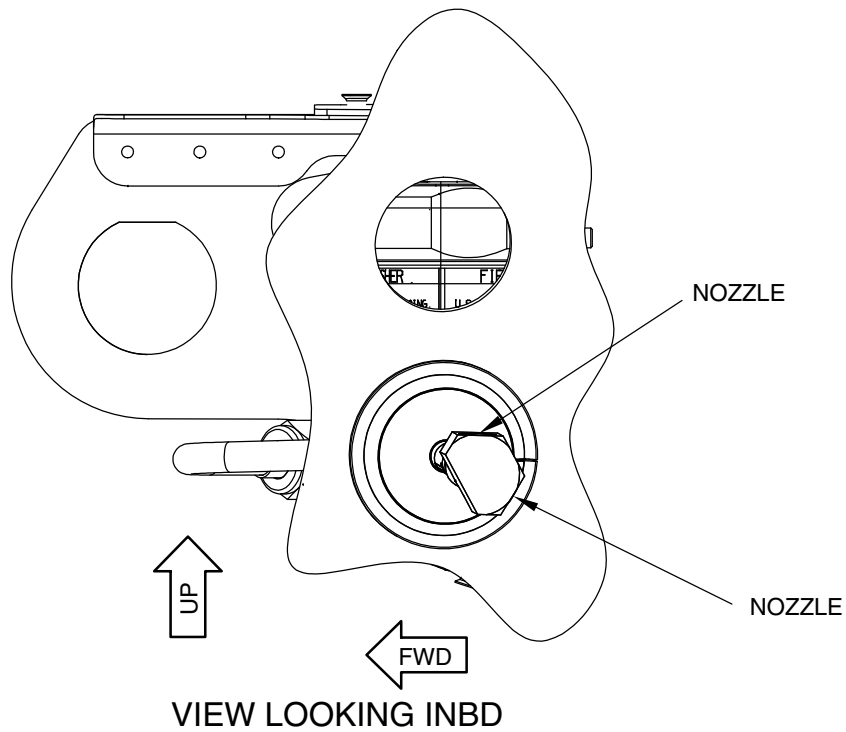
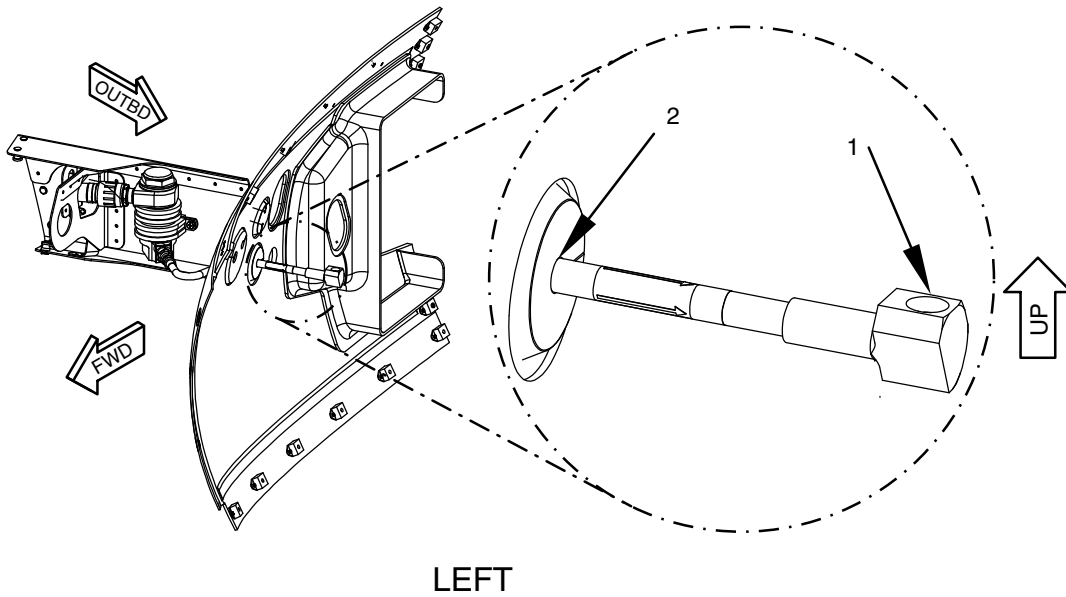

**Left Fire Suppression Tubing  
Figure 1 (Sheet 2 of 2)**

5121593A



## SERVICE BULLETIN

- (c) Visually examine fire suppression nozzle (1, Figure 1) position. Alignment of nozzle (1, Figure 1) must be facing up as shown in Figure 1.
- (d) On right side, visually examine mounting clip (3, Figure 1). Make sure that clip is not bent or detached from tubing. Replace tubing if damaged. Refer to AMM - 26-20-10 - FIRE EXTINGUISHER CARTRIDGE - REMOVAL (effectivity noted) and AMM - 26-20-10 - FIRE EXTINGUISHER CARTRIDGE - INSTALLATION (effectivity noted).

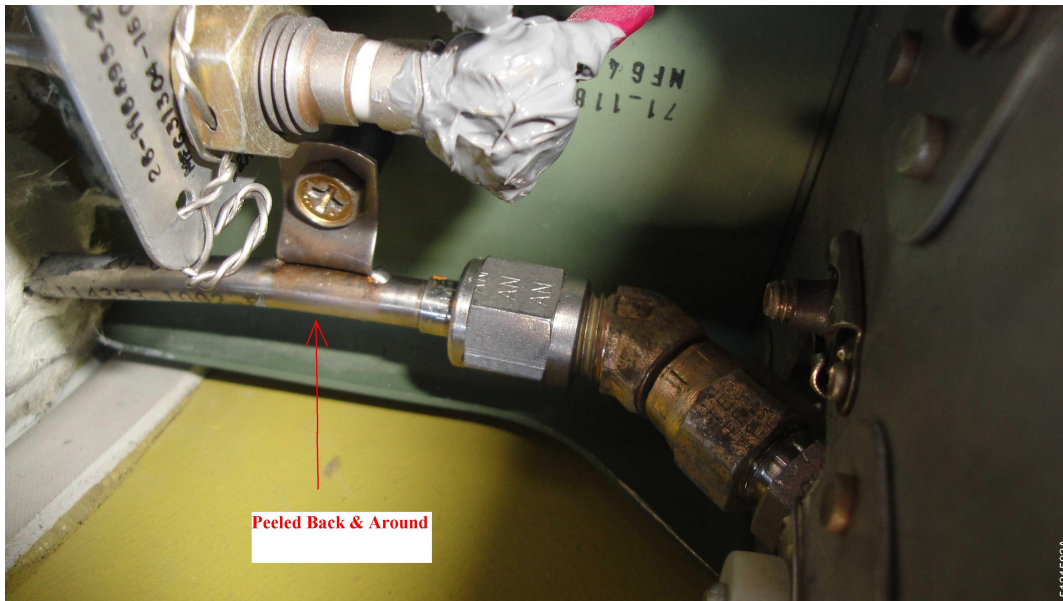

**Example of Damaged RH Tube Mounting Clip  
Figure 2**

- (e) Make sure that all hardware is secure.
- (3) **Job Close-up**
- (a) Install Left Pylon Leading Edge - 311 EL. Refer to AMM - 54-30-11 - LEADING EDGE PYLON SKIN - INSTALLATION.
  - (b) Install Left Upper Nacelle Cowl - 411 AT. Refer to AMM - 54-20-21 - UPPER NACELLE - INSTALLATION.
  - (c) Install Right Pylon Leading Edge - 312 BR. Refer to AMM - 54-30-11 - LEADING EDGE PYLON SKIN - INSTALLATION.
  - (d) Install Right Upper Nacelle Cowl - 412 AT. Refer to AMM - 54-20-21 - UPPER NACELLE - INSTALLATION.
  - (e) Close the circuit breakers that follow:
    - ECB - L ENG FIRE EXTNGR (L FWD Bus)
    - ECB - R ENG FIRE EXTNGR (R FWD Bus)
  - (f) If all other maintenance is complete, return the aircraft to service. Refer to the AMM - 20-00-02 - RETURN TO SERVICE (AFTER MAINTENANCE).



**MANDATORY**

ECLIPSE  
AEROSPACE

## SERVICE BULLETIN

---

### **B. Limitations and Procedures**

None

### **C. Cost**

Contact Eclipse Aerospace Inc. for cost and availability.

### **4. RECORD OF COMPLIANCE**

Upon completion of this Service Bulletin, make an appropriate maintenance-record entry specifying the Service Bulletin number.

### **5. NOTIFYING ECLIPSE AEROSPACE**

On completing this service bulletin, the operator/maintainer shall complete the attached Compliance Record and send it to Eclipse Aerospace via regular mail, fax, or e-mail.

Mailing Address	Eclipse Aerospace Incorporated ATTN: Service Engineering 2503 Clark Carr Loop SE Albuquerque, NM 87106
Fax	1-505-241-8802
E-mail	sbcompliance@eclipse.aero

